

PC TC PRO, 1/2x9 – 70 W

PC PRO compact

With PC PRO you get the maximum from a fluorescent lamp. x ll processor technology ensures an intelligent balance of tolerances for extremely precise lamp operation. As a result of this careful treatment, the lamps feature a long service life, even after more than 50,000 starts. In this regard it is no problem if ambient temperatures fluctuate between -25 °C and up to 80 °C according to the specific version. With overvoltage caused by erroneous wiring, the supplementary Intelligent Voltage Guard protective function outputs a warning.

**Product description**

- _ CELMA Energy Efficiency Index A2 BAT / A2
- _ Nominal life-time up to 50,000 h (at ta 50 °C with a failure rate ≤ 0.2 % per 1,000 h)
- _ Large temperature range (for values see table)
- _ Devices can operate either 1 or 2 lamps
- _ Intelligent Voltage Guard (overvoltage indication and undervoltage shutdown)
- _ Constant luminous flux irrespective of fluctuations in mains voltage
- _ For luminaires of protection class I and protection class II
- _ Automatic start after replacement of defective lamps
- _ Safety shutdown of defective lamps and at end of lamp life (EOL 2)
- _ For emergency lighting systems as per EN 50172
- _ For luminaires with M and MM as per EN 60598, VDE 0710 and VDE 0711
- _ Temperature protection as per EN 61347-2-3 C5e

Website

<http://www.tridonic.com/22176407>



PC TC PRO, 1/2x9 – 70 W

PC PRO compact

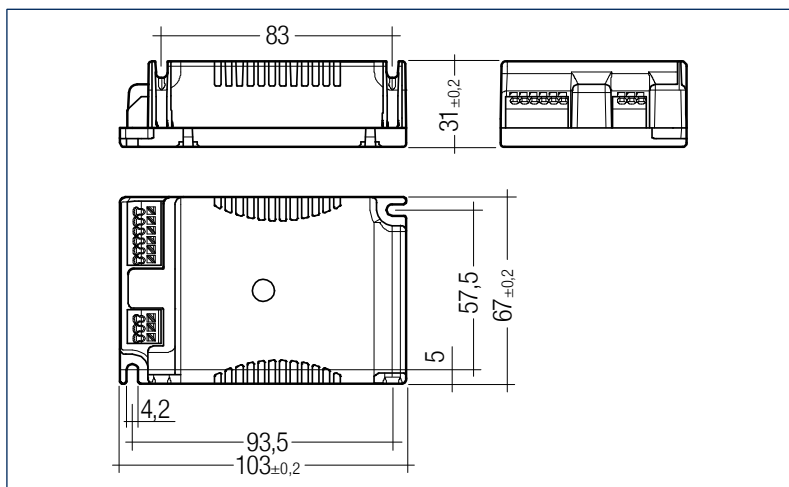

Ordering data

Type	Article number	Packaging, carton	Packaging, low volume	Weight per pc.
For luminaires with 1 or 2 lamps				
PC 1/2x18 TC PRO	22176407	15 pc(s).	750 pc(s).	0.130 kg

Technical data

Mains voltage range	220 – 240 V
AC voltage range	198 – 264 V
DC voltage range	176 – 280 V (lamp start ≥ 198 V DC)
Mains frequency	0 / 50 / 60 Hz
Overvoltage protection	320 V AC, 1 h
Defined warm start	≤ 1.6 s
Operating frequency	≥ 40 kHz
Type of protection	IP20

Approval marks



Standards

EN 55015, EN 60929, EN 61000-3-2, EN 61347-2-3, EN 61347-2-4, EN 61547, Acc. to EN 50172

Specific technical data

Lamp wattage	Lamp type	Type	Article number	Dimensions L x W x H	Lamp power	Circuit power	EEI	Current at 50 Hz		λ at 50 Hz		tc, point max.	Ambient temperature ta	tc/ta for ≥ 50, 000 h
								220 V	240 V	220 V	240 V			
For luminaires with 1 or 2 lamps														
1 x 18 W	TC-DEL	PC 1/2x18 TC PRO	22176407	103 x 67 x 31 mm	16.7 W	18.7 W	A2 BAT	0.090 A	0.082 A	0.95	0.94	75 °C	-25 ... +70 °C	75/70 °C
2 x 18 W	TC-DEL	PC 1/2x18 TC PRO	22176407	103 x 67 x 31 mm	33.6 W	36.5 W	A2 BAT	0.170 A	0.156 A	0.98	0.98	75 °C	-25 ... +65 °C	70/60 °C
1 x 18 W	TC-TEL	PC 1/2x18 TC PRO	22176407	103 x 67 x 31 mm	16.6 W	18.8 W	A2 BAT	0.090 A	0.083 A	0.95	0.94	75 °C	-25 ... +70 °C	75/70 °C
2 x 18 W	TC-TEL	PC 1/2x18 TC PRO	22176407	103 x 67 x 31 mm	34.8 W	37.3 W	A2 BAT	0.174 A	0.159 A	0.98	0.98	75 °C	-25 ... +65 °C	70/60 °C

The complete data sheet for this product is available in the Downloads section.