

# LETARON® 广东擎洲光电科技股份有限公司

## Letaron Electronic Co., LTD

Address: No. 253, Junma Road, Hengli Town, Dongguan City, Guangdong Province, China

地址: 广东省东莞市横沥镇骏马路 253 号

Tel: +86 769 89110666 Fax: +86 769 87060909

E-Mail: [Sales@letaron-group.com](mailto:Sales@letaron-group.com) Postcode: 523460 Website: [www.letaron-group.com](http://www.letaron-group.com)

### ENGINEERING SPECIFICATION

### 工程規格書

客戶 / CUSTOMER : \_\_\_\_\_  
產品名稱 / ITEM : **Human body inductive switch**  
顏色/Colour : **Black**  
客戶編號 / CUSTOMER P/N : \_\_\_\_\_  
擎洲样品申请单号/Samples request No : \_\_\_\_\_  
擎洲产品型號 / OUR MODEL NO. : **PIR120-L / HEKPIR0023**  
標準 / STANDARD : \_\_\_\_\_  
額定 / RATING : **Input: DC12/24V I<sub>max</sub>=3A**  
: **Output: DC12/24V I<sub>max</sub>=3A**  
備注 / REMARKS : **RoHS STANDARD**

根據本公司政策規定,貴司必須於該產品首次生產之前簽回我司規格書的首頁、銘牌共二頁,以確認該產品之規格。

另外,請貴司於下單時在採購單上打上本公司產品編號以及样品单编号,以避免生產錯誤。

如貴司未能如期簽回規格書,我司將無法為該產品安排生產。

為免延誤貴公司之出貨時間,請貴司通力合作。

Based on the policy of our company ,all buyers MUST return this product specification sheets along with signature

And company chop. Please study very carefully and sign the page of Engineering Specification /Nameplate for product confirmation. And also, please mark our products Model No and Samples request No while the PO issue.

NOTICE: This is very important to have this specification sheets confirmed and return to us on time to avoid any mistake

Or delay of delivery. Without your confirmation, Letaron Electronic would not arrange to start the production for your company.

版本 REV.	描述/DESCRIPTION	日期 DATE	制作人 PREPARED BY
00	首次發行/FIRST ISSUE	2022/12/24	彭年

### 擎洲/LETARON

	制作 Prepared	检查 Checked	核准 Approved
签名 Signature			
日期 Date			

### 客戶/CUSTOMER

確認  
Approved by

日期  
Date

(簽字或公司蓋章)  
(Signature and company stamp)

# LETARON® 广东擎洲光电科技股份有限公司

## Letaron Electronic Co., LTD

Address: No. 253, Junma Road, Hengli Town, Dongguan City, Guangdong Province, China

地址: 广东省东莞市横沥镇骏马路 253 号

Tel: +86 769 89110666 Fax: +86 769 87060909

E-Mail: [Sales@letaron-group.com](mailto:Sales@letaron-group.com) Postcode: 523460 Website: [www.letaron-group.com](http://www.letaron-group.com)

### 1. Environment(环境):

working temperature of  $0^{\circ}\text{C}\sim 45^{\circ}\text{C}$ , 10%~90%RH (without dew point);  
(工作温度  $0^{\circ}\text{C}\sim 45^{\circ}\text{C}$ , 湿度 10%~90%RH (无凝露));

Storage temperature:  $-20^{\circ}\text{C}\sim 85^{\circ}\text{C}$ , 10%~90%RH (without dew point);  
(存储温度  $-20^{\circ}\text{C}\sim 85^{\circ}\text{C}$ , 湿度 10%~90%RH (无凝露));

### 2. Instruction(用法说明):

2-1. Turn off the power connection before installation.(安装前要切断电源).

2-2. Indoor use only. (仅供室内使用).

2-3. Load of the secondary shall not exceed the rated power.(负载不可超过额定功率).

2-4. Installation shall be done by qualified technician.(要有一定专业知识的人才能安装).

2-5. Make sure all the cables connected correctly before turn on the power.

(接通电源前要确定所有的电线连接正确).

2-6. Maximum ambient temperature  $45^{\circ}\text{C}$ , 最大工作环境温度  $45^{\circ}\text{C}$

### 3. Externality figure and name plate (外形图):

#### 3-1 外形图

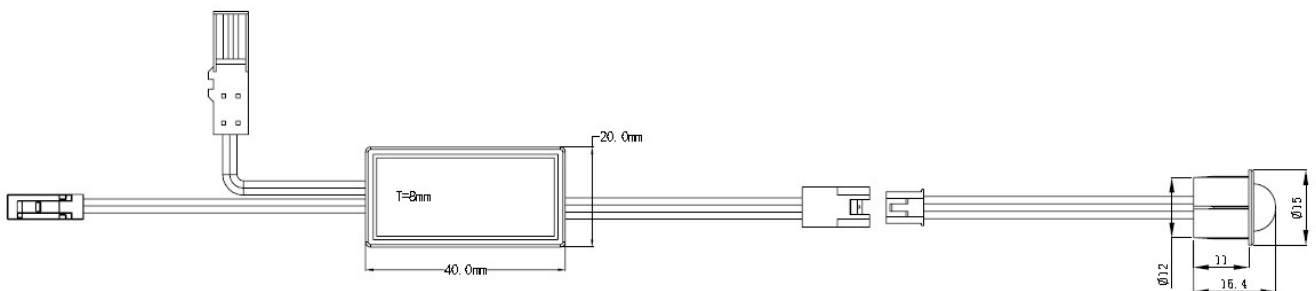

#### 3-2 感应头尺寸

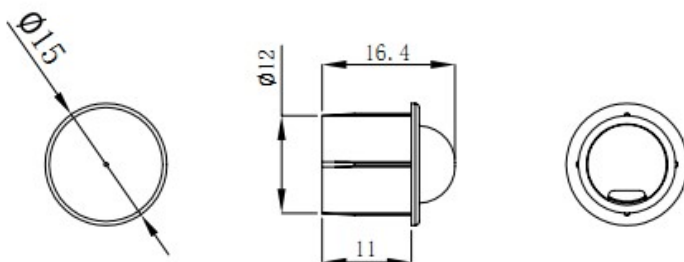

# LETARON® 广东擎洲光电科技股份有限公司

## Letaron Electronic Co., LTD

Address: No.253, Junma Road, Hengli Town, Dongguan City, Guangdong Province, China

地址: 广东省东莞市横沥镇骏马路 253 号

Tel: +86 769 89110666 Fax: +86 769 87060909

E-Mail: [Sales@letaron-group.com](mailto:Sales@letaron-group.com) Postcode: 523460 Website: [www.letaron-group.com](http://www.letaron-group.com)

### 3-3 产品丝印

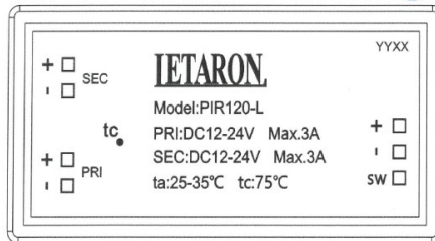

### 4. Production test specification(生产测试规格):

序号 item	测试项目 test project	最小值 Min	典型值 Typical value	最大值 Max	备注 remarks
1	Semi finished product test, standby input current	--	--	3A	DC 12Vinput
2	Semi finished product test, standby input current	--	--	3A	DC 24Vinput
3	Induction mode	Manual scanning induction			
4	Finished product test, input current	--	--	3A	DC 12Vinput
5	Finished product test, output current	--	--	3A	DC 24Vinput
6	Sensing distance test	2.5M min			
7	Time test	30±5s (The test time is calculated from the last time when the human body leaves the sensing area)			
8	Test height and angle	1.6M Angle range: about 60°			
9	Lifetime	30000H			
10	function	When human body movement is sensed within 2.5 meters, LED is on. The LED light will turn off automatically about 30 seconds after the person leaves the sensing range. Note: After the light is turned on, the human body still walks in the sensing range and the off time is prolonged.			Output high and low level signals

**LETARON® 广东擎洲光电科技股份有限公司**  
**Letaron Electronic Co., LTD**

Address: No. 253, Junma Road, Hengli Town, Dongguan City, Guangdong Province, China

地址: 广东省东莞市横沥镇骏马路 253 号

Tel: +86 769 89110666 Fax: +86 769 87060909

E.Mail: [Sales@letaron-group.com](mailto:Sales@letaron-group.com) Postcode: 523460 Website: [www.letaron-group.com](http://www.letaron-group.com)

---