

Touch Sensor (Low Voltage)

KZQ-CM-BC

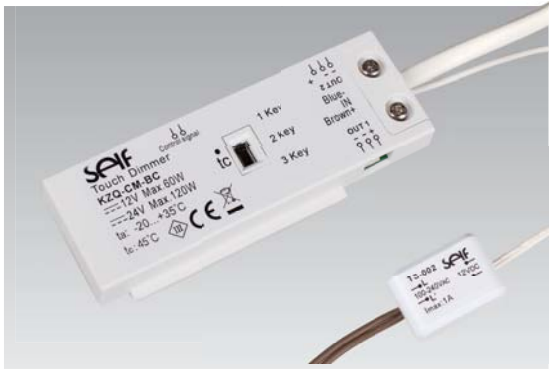

Dimensions: (mm/inch)

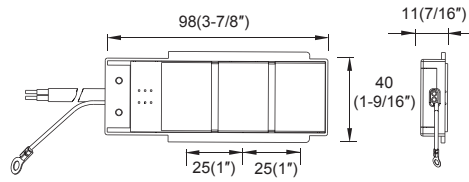

Accessories:

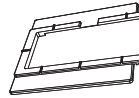

Installation bracket with double-sided adhesive tape

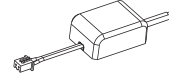

TS-002 (Optional)
(12V or 24V version)



- Touch sensor
- Used behind mirror
- Memory function

Function:

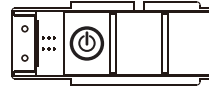
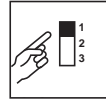

- ⏻ Short touch (< 1s): On/Off
- ⏻ Long touch (> 1s): Dimming from 5%~100%

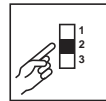

- ⏻ Short touch (< 1s): On/Off
- ⏻ Long touch (> 1s): Dimming from 5%~100%
- ⏻ Short touch (< 1s): adjust CCT to cold white, nature white, warm white
- ⏻ Long touch (> 1s): adjust CCT from cold white to warm white

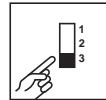

- ⏻ Short touch (< 1s): On/Off
- ⏻ Short touch (< 1s): adjust CCT to cold white, nature white, warm white
- ⏻ Long touch (> 1s): adjust CCT from cold white to warm white
- ⏻ Short touch (< 1s): Dimming level 5%,30%,60%,100%
- ⏻ Long touch (> 1s): Dimming from 5%~100%

Specifications

Model No.	Rated input	Rated load	Thickness of mirror	ta	L x W x H
KZQ-CM-BC	DC 12V	2 x 30W	Less than 5mm is recommended	-20~35°C	98x40x11mm (3-7/8"x1-9/16"x7/16")
	DC 24V	2 x 60W			

*For product datasheet go to www.self-ecg.com or available on request.

The ON/OFF of Electric heating element is Synchronous with KZQ-CM-BC via the TS-002

