

2464 22AWG/IPR AND
24AWG/2C
80° C 300V

| | | |
|----------|-------|----------|
| USB-4PIN | | OUT-5PIN |
| PIN1 V+ | 24AWG | PIN1 V |
| PIN1 V+ | | PIN9 V+ |
| PIN4 V- | | PIN1 V- |
| PIN4 V- | 24AWG | PIN12V- |

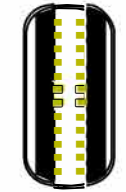

USB

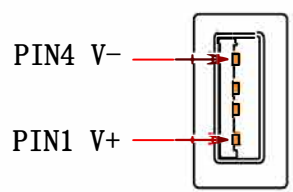

OUT 5PIN

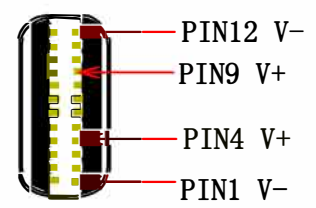

THIRD ANGLE PROJECTION

UNLESS OTHERWISE SPECIFIED

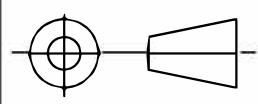

DIMENSIONS ARE IN MM
TOLERANCES ON:
1 PL DECIMALS ±
2 PL DECIMALS ±
ANGLES ±
FRACTIONS ±

USB-TYPE-C

